

Coming Soon -  
High Quality 4,022 Sq Ft  
Plug & Play Office

# ONE THIRTY W1

SHAFTESBURY AVENUE



Ground floor reception with soft seating



# THE STAGE IS SET.

- 01 Reception
- 02 Exterior

Welcome to One Thirty Shaftesbury Avenue on the border of Soho and Covent Garden.

This striking building has been transformed by Thirdway, to provide thoughtfully designed workspace. The part 4th floor will offer 4,022 sq ft of new Plug & Play fitted workspace.



Plug & Play fitted workspace



Prime Covent Garden and Soho location



Commissionaire and 24/7 security & access



Efficient floorplate and high levels of natural light



Secure cycle spaces and bike repair station



12 showers and drying room



3 passenger lifts



Exposed services with LED lighting



7 car parking spaces available



Refurbished WCs

# A REAL SHOWSTOPPER.

Designed to the highest standards with accent details and a contemporary colour palette, the part 4th floor offers an ideal space for businesses looking to hit the ground running and get straight to work.



- 
- 01 4th floor kitchenette / breakout area CGI
  - 02 4th floor office CGI
-



# PART 4TH FLOOR

4,022 sq ft / 374 sq m  
Fitted (Plug & Play)

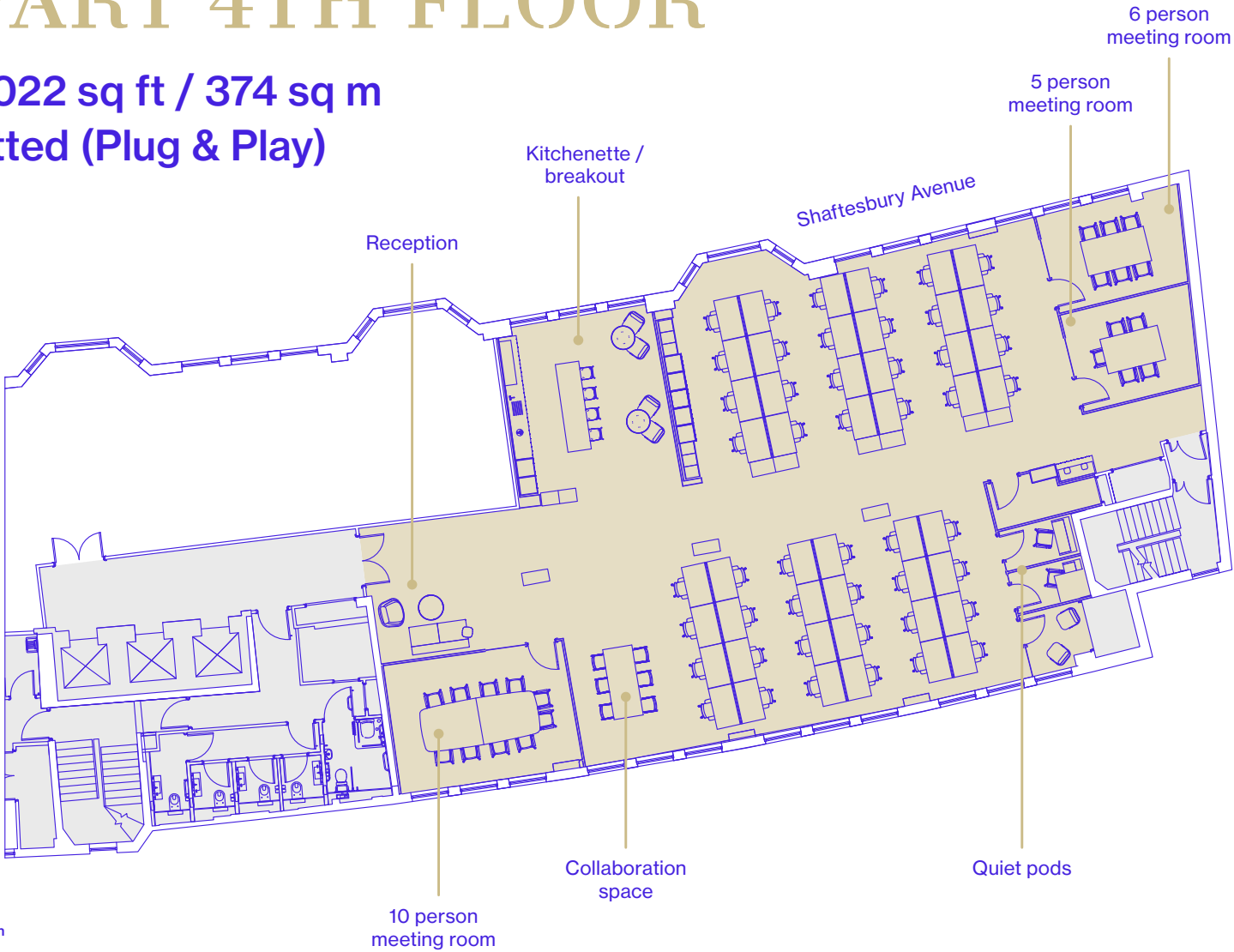

For indicative purposes only.  
Not to scale.

Reception area	Kitchenette breakout space
48 fixed desks	Collaboration space
2 meeting rooms	10 person boardroom
2 quiet pods	Fibre & internet enabled

# IN THE LIMELIGHT.

In the heart of London's theatre district, with Soho and Covent Garden on your doorstep – the local area offers a vibrant and eclectic mix of amenities morning, day and night.



- 01 Seven Dials Market
- 02 Brasserie Max
- 03 Dean Street Townhouse

- 04 Simmons Soho
- 05 Floral Street
- 06 Temper
- 07 Lina Stores



# IN THE ROUND.

Five underground stations are within easy reach of 130 Shaftesbury Avenue. The Elizabeth Line at Tottenham Court Road has reduced travel times across the City, whilst National rail services are available from Charing Cross station.

<b>Restaurants</b>	<b>Retail</b>	<b>Leisure</b>
1. The Ivy	15. APC	30. Soho House
2. The Petersham	16. Arket	31. Outernet
3. Noble Rot	17. Apple	32. Curzon Soho
4. Hoppers	18. Paul Smith	
5. La Bodega Negra	19. Le Labo	<b>Occupiers</b>
6. Ceconi's	20. Magma	33. Deckers
7. Louie	21. YMC	34. Brebners
8. Berenjak		35. Robert Walters
	<b>Gyms</b>	36. Red Bull
	22. Gymbox	37. 20th Century Fox
<b>Bars / Pubs</b>	23. Third Space	38. Dolby
9. Bar Termini	24. Digne	39. Tripadvisor
10. BrewDog	25. Fitness First	40. Palantir
11. The Dog & Duck		41. Bank of East Asia
	<b>Hotels</b>	42. Hogarth
<b>Cafés</b>	26. The Z Hotel	43. NBA
12. Monmouth Coffee	27. Mercer Street Hotel	44. Hearst
13. Hideaway Coffee	28. Covent Garden Hotel	45. NFL
14. Bar Italia	29. The Soho	46. Google
		47. NBC Universal
		48. Peloton



Leicester Square



Tottenham Court Rd



Piccadilly Circus



Covent Garden



Charing Cross



## Terms

Upon application.

## Viewings

Strictly through the joint sole letting agents.

**James Swan**  
07763 204 714  
james.swan@jll.com

**Isabella Woodhead**  
07709 507 329  
isabella.woodhead@jll.com



**James Taylor**  
07899 843 767  
james.taylor@eur.cushwake.com

**Gina Stevens**  
07775 112 999  
gina.stevens@cushwake.com



# onethirtyw1.london

JLL and Cushman & Wakefield give notice that these particulars are set out as a general outline only for the guidance of intending Purchasers or Lessees and do not constitute any part of an offer or contract. Details are given without any responsibility and any intending Purchasers, Lessees or Third Party should not rely on them as statements or representations of fact, but must satisfy themselves by inspection or otherwise as to the correctness of each of them. No person employed or engaged by JLL nor Cushman & Wakefield has any authority to make any representation or warranty whatsoever in relation to this property. March 2025.