

FIVE

Endeavour Square
Stratford



85,000 sq ft
stunning, fully
fitted offices

Floor	Sq Ft	Sq M
7th	28,103	2,610
6th	28,103	2,610
5th	28,648	2,661
Total	84,854	7,883

Designed by Rogers Stirk Harbour + Partners and occupied by Transport for London, 5 Endeavour Square is a landmark building offering fully fitted and flexible sublease arrangements on the 5th, 6th and 7th floors.



SURROUNDED
BY LANDSCAPED
PUBLIC REALM

A better workplace

Step in from the tree-lined public realm and enter the building's bright reception hub, which offers 24-hour access and friendly concierge.

The onsite cafe and communal roof terrace help shape the ideal environment to balance work and wellbeing.



Roof terrace

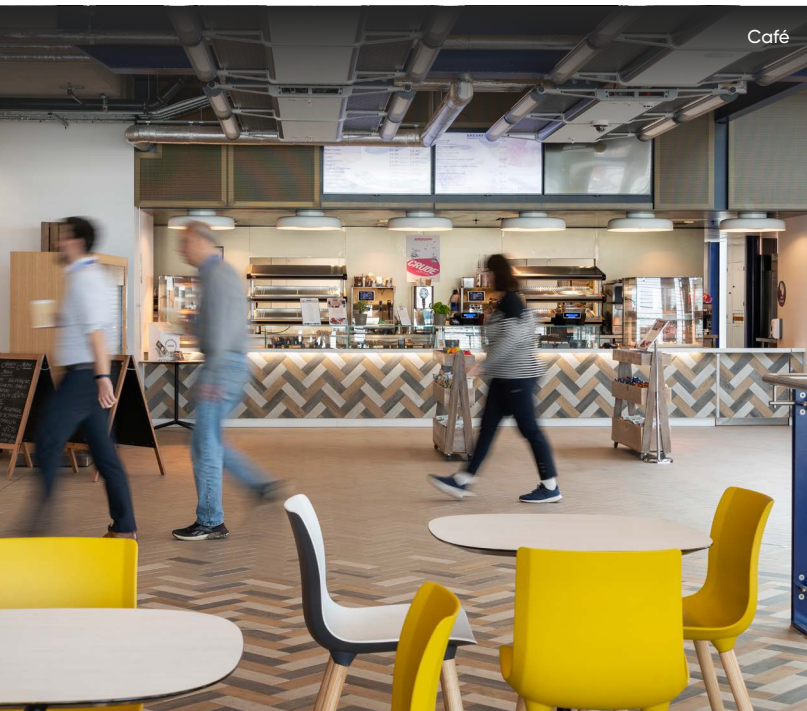

24 HOUR ACCESS
WITH A FREINDLY
CONCIERGE



EXCELLENT
END-OF-JOURNEY
FACILITIES

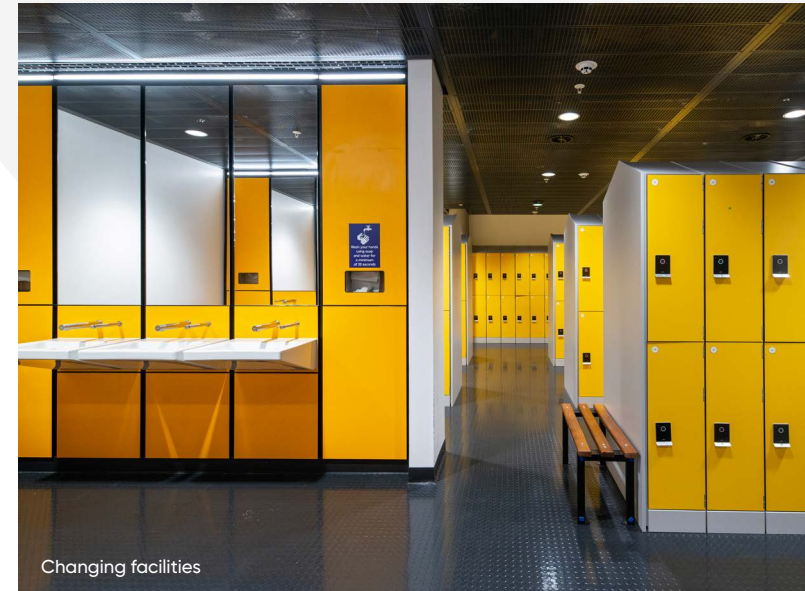



Ready to work

Get down to business right away. The space has been fully kitted-out to a top quality specification to make working smooth and efficient.

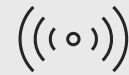

High speed
fibre connection



EPC Rating:
B



Fitted out
space

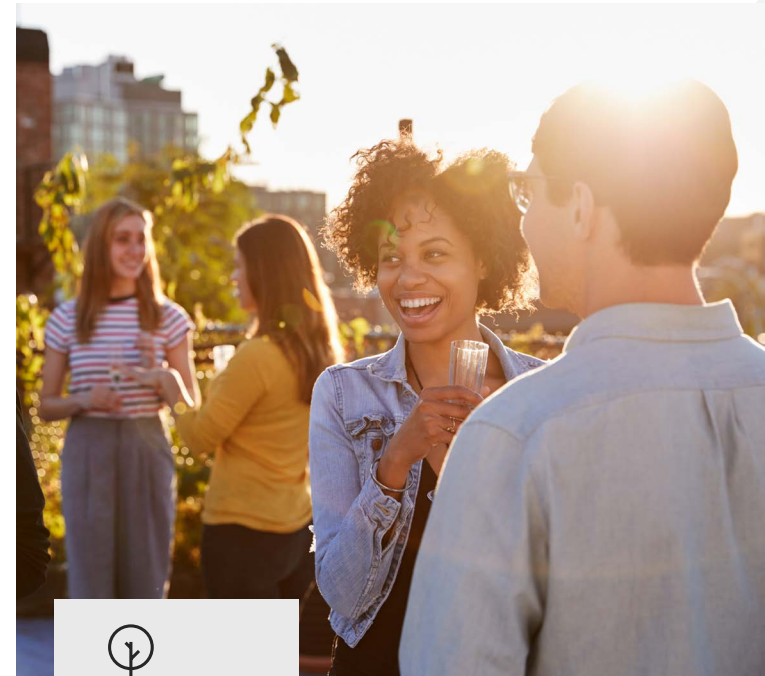

Communal roof
terrace



On-site
café



Arrive in style

5 Endeavour Square provides a warm welcome, however you chose to travel – so you can start your day comfortably.



Secure bike
storage



Showers and
changing rooms

Stay for the extras

Enjoy your workplace in the range of communal areas.
The roof terrace





6th Floor
Indicative Fitted CGI

Fifth Floor

28,648 Sq Ft / 2,661 Sq M

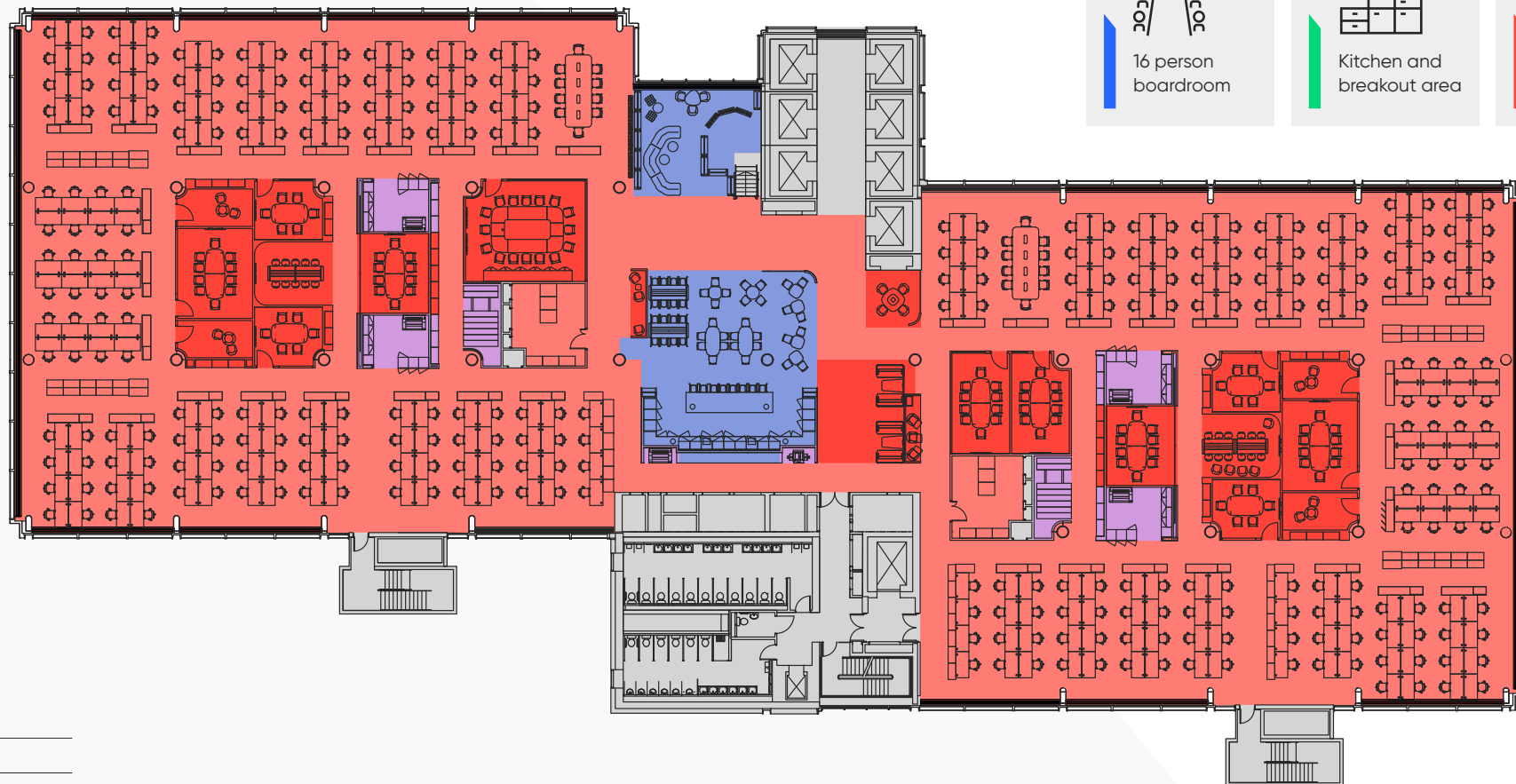
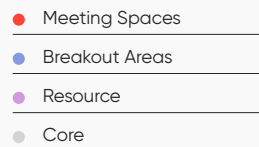
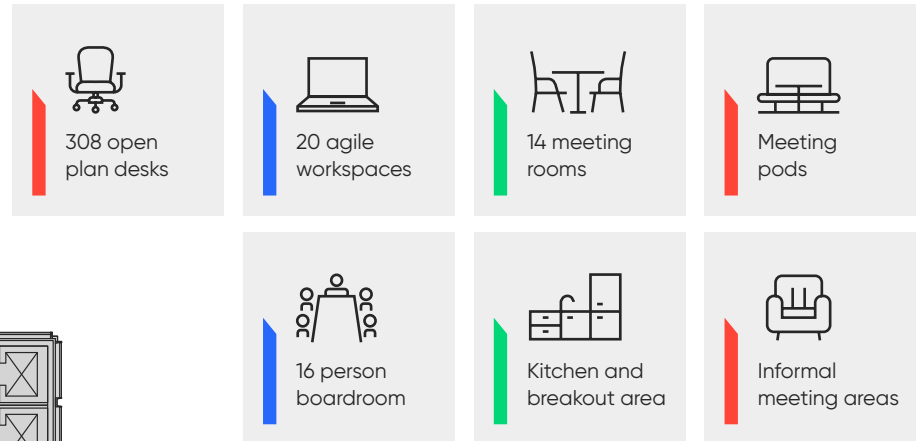

For indicative purposes only.
Not to scale.

Sixth Floor

28,103 Sq Ft / 2,610 Sq M

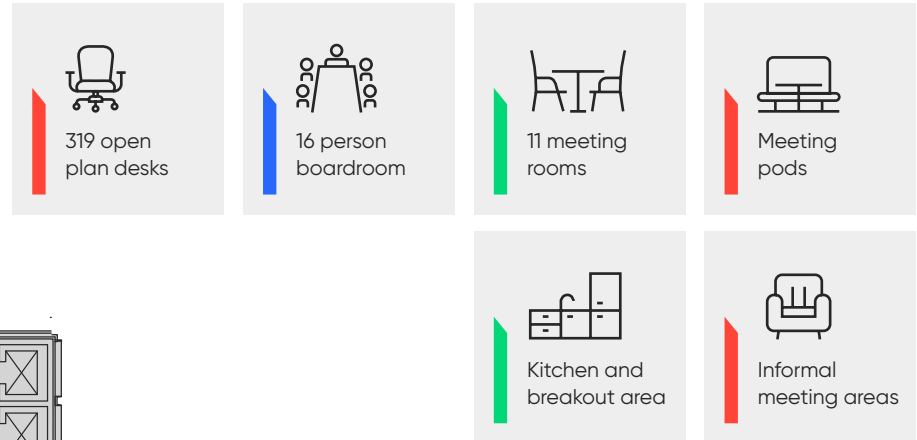

- Meeting Spaces
- Breakout Areas
- Resource
- Core

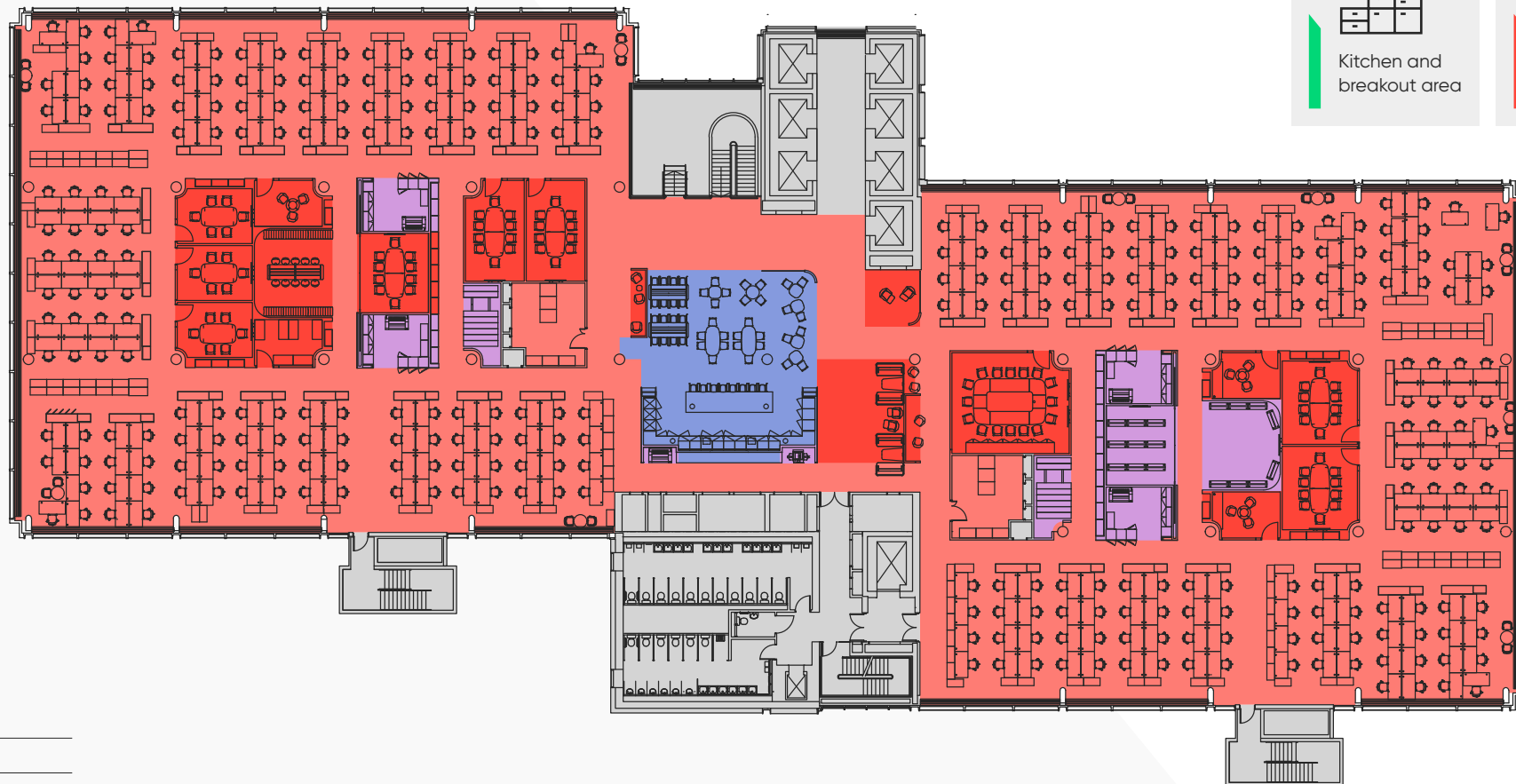

For indicative purposes only.
Not to scale.

Seventh Floor

28,103 Sq Ft / 2,610 Sq M



307 open
plan desks



16 person
boardroom



10 meeting
rooms



Meeting
pods

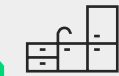

Kitchen and
breakout area



Informal
meeting areas

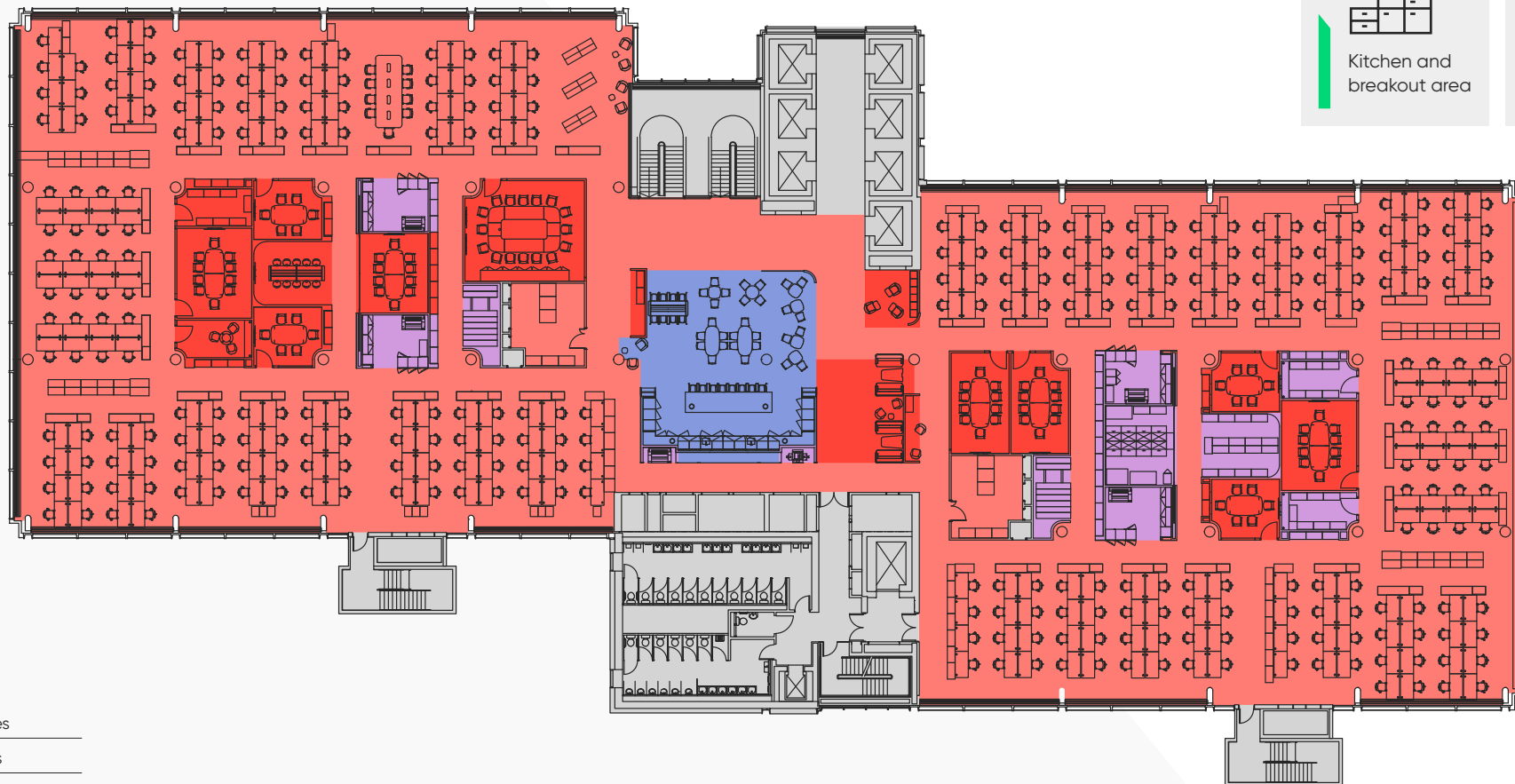

● Meeting Spaces

● Breakout Areas

● Resource

● Core



For indicative purposes only.
Not to scale.

Work & play

IQL Stratford is London's vibrant workplace district. Set against the East Bank's rich art and cultural backdrop, it combines the very best of the city's restaurants, entertainment and shopping.



2 MINS
WALK TO THE
RIVERSIDE





Fast connections

With exceptional transport links, Stratford provides easy access to the City in just 7 minutes via the Elizabeth Line and St Pancras International by rail. London City Airport can be reached by DLR in under 15 minutes.

06 mins

Stratford





07 mins

Liverpool St



09 mins

Farringdon



42 mins

Heathrow



Local occupiers

01 

02 

03 

04 

05 

06 

07 

08 

09  National Institute for Health and Care Excellence

10  Transport for London

11 

12  FINANCIAL CONDUCT AUTHORITY

Terms

Upon application.

Viewings

Strictly by appointment through
sole letting agent.

Holly Hamer

07471 725 112

holly.hamer@cushwake.com

Alistair Brown

07771 527 350

alistair.brown@cushwake.com



5endeavoursquare.com

Cushman & Wakefield copyright 2020. No warranty or representation, express or implied, is made to the accuracy or completeness of the information contained herein, and same is submitted subject to errors, omissions, change of price, rental or other conditions, withdrawal without notice, and to any special listing conditions imposed by the property owner(s). As applicable, we make no representation as to the condition of the property (or properties) in question.

Designed and produced by Cre8te – 020 3468 5760 – cre8te.london

