

CT5 The Podium



Your future is boundless

Unique self-contained workspace
opportunity available to lease
46,350 sq ft | 29,904 sq m

New York Street, Manchester, M1 4BT
www.citytower-manchester.co.uk



Contents

A rare opportunity	3
The Podium floor plan	4
Making your mark	5
The Podium specification	7
Heritage and purpose	8
Ahead of the curve	9
At the centre of it all	10
Everything for effortless daily life	14
Our building	20
Repurpose + reuse	21
Building amenities	22
Connectivity	23
Skylounge	25
Lets work well together	27

A rare opportunity

Seize a rare opportunity to lease one of the largest floorplates in Manchester city centre on the Podium at City Tower. With a floor plate of 46,350 sq ft, this expansive and open space will enable your business to create a multitude of different workspace zones, collaboration and amenity areas, all conveniently situated on a single floor.

The unique self contained large floor plate opportunity will appeal to a variety of occupiers, also offering the opportunity to bring your brand to the street.

Situated in a prime location with dual frontages onto Piccadilly Gardens and Portland Street, the space offers unparalleled visibility and significant branding opportunities in one of Manchester's busiest and most vibrant areas.

[The Podium space on offer >](#)



The Podium floor plan

The Largest Single Office Floor
Plate in Manchester City Centre



46,350 sq ft



Precedent images ↑

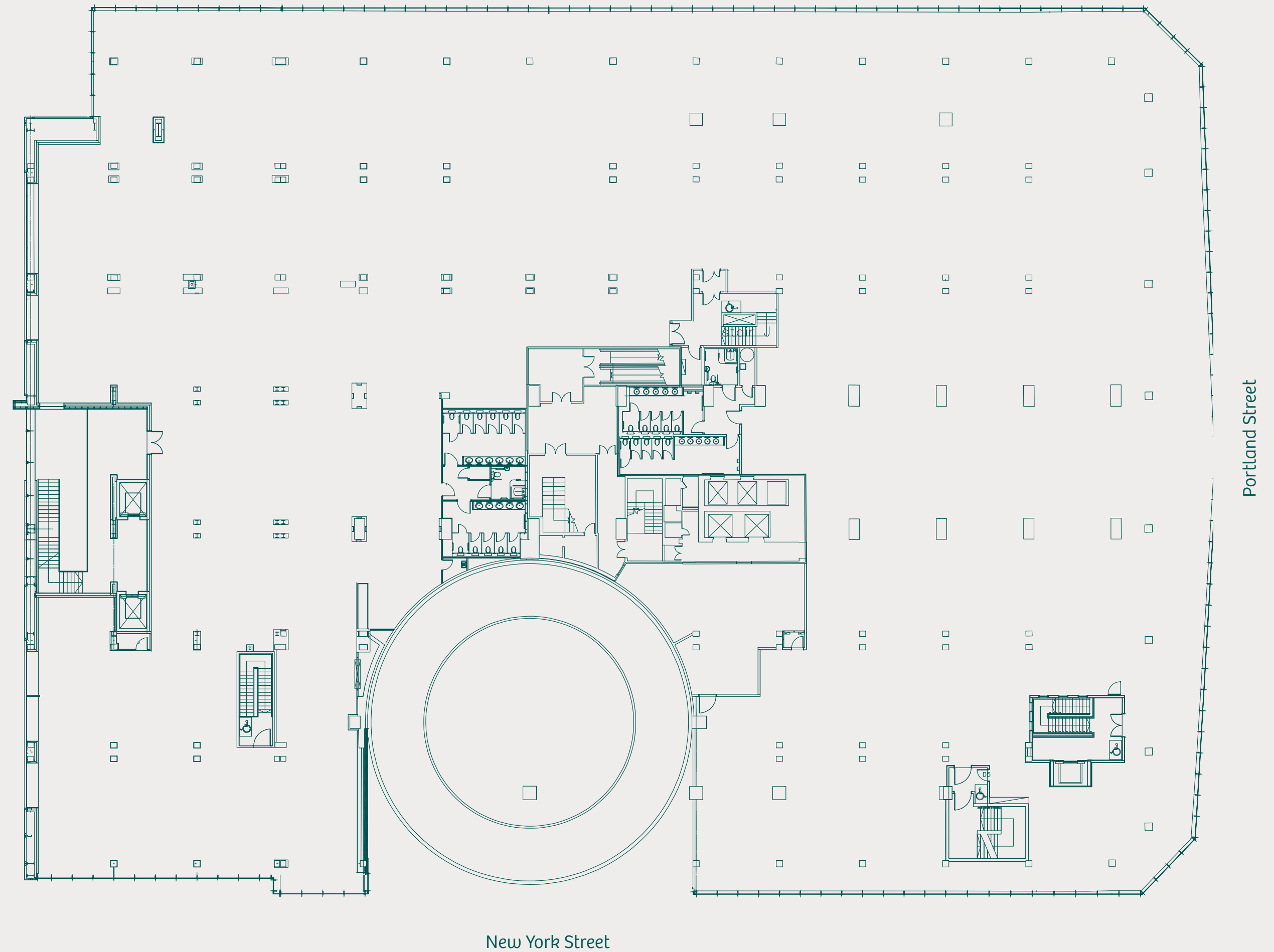

Making your mark

46,350 sq ft



key

-  360 workstations
-  Kitchen / breakout space
-  17 meeting / focus rooms
-  Client lounge
-  Stairs / toilets

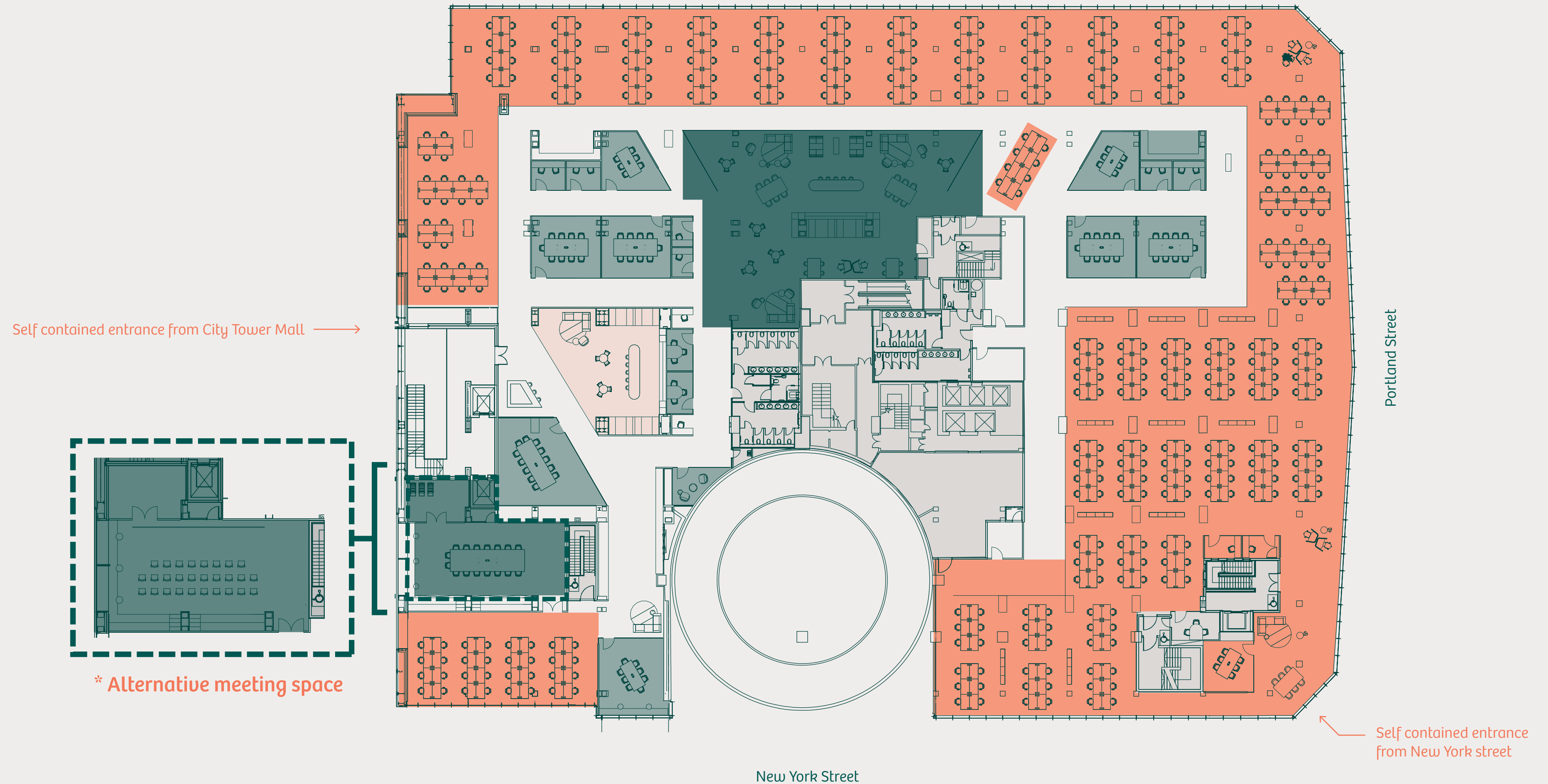

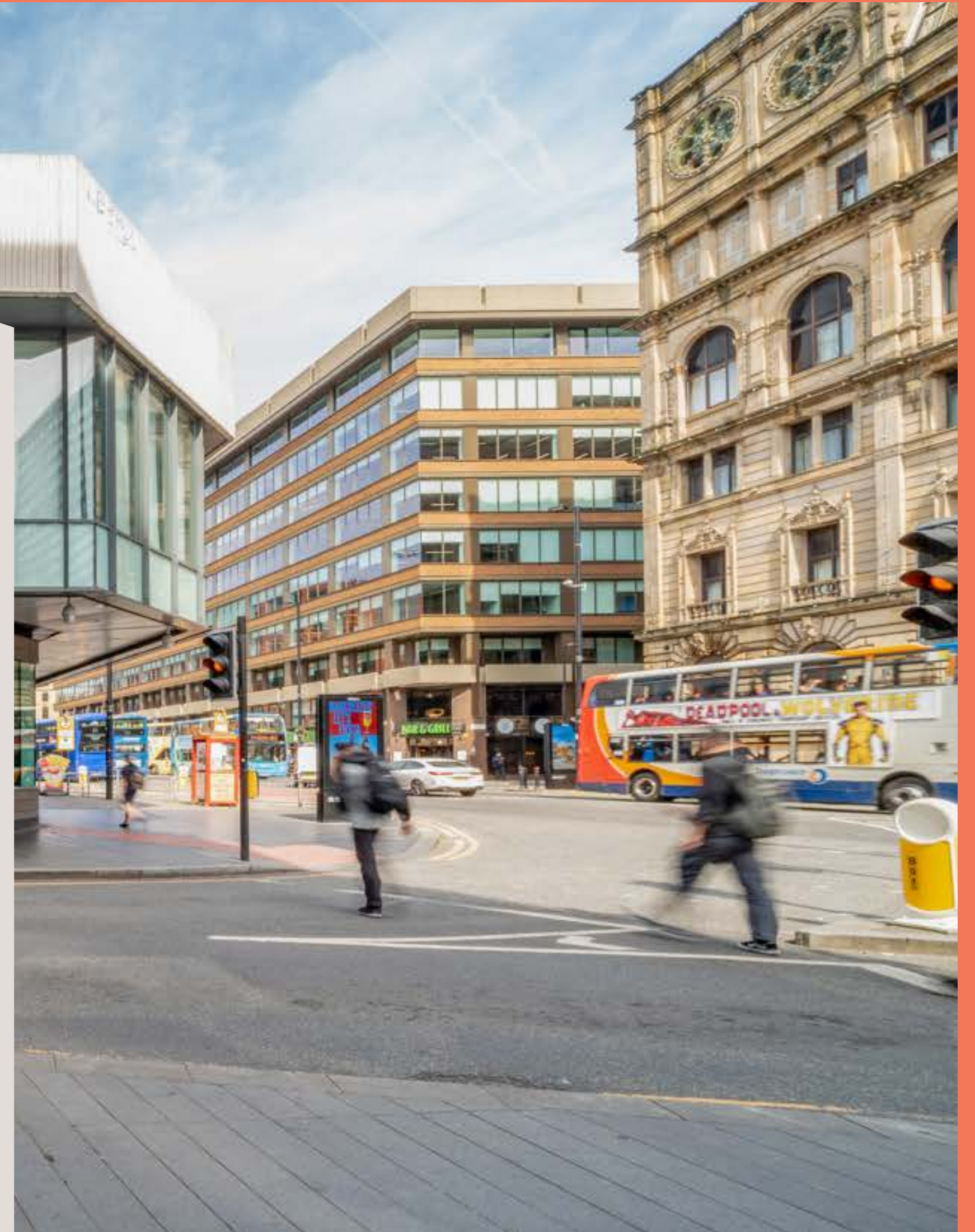

Additional dedicated entrance from New York Street ↑

The Podium specification



New heating, cooling and ventilation system

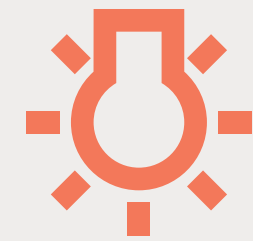

LED lighting

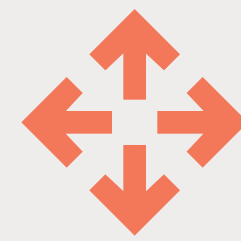

Open and expansive floor plate



360 degree, unrivalled views



Exposed services



Skylounge – 28th floor business lounge and events space



2x self-contained entrances



Secure fob access speed gates

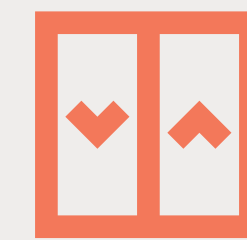

2 x passenger lifts



Changing and drying room facilities at Podium level (48 lockers)



Dedicated showers at Podium level (9 showers & 1 accessible shower)



Ground floor business lounge



Disabled access



On-site car parking



Secure bicycle storage (65 bike racks & 44 lockers)



Regular on-site fitness classes (yoga and pilates) and events for tenants



Extensive amenity offering at ground floor level – shops, bars, restaurants and hotel



Wired Score Platinum – High speed internet with access to a range of providers



Greater Manchester Cycle Hub situated on-site



Male, female, disabled WC's



Heritage and purpose

The most sustainable way of creating workspace is to use what already exists and City Tower has stood the test of time.

In 1959, architects Couell Matthews and Partners unveiled their radical plans for the creation of an exciting new space. Bold and unorthodox at the time, the scheme comprised three towers which sat atop a podium that ran the entire length of Parker Street.

The man chosen to make it all happen was Bernard Sunley, one of the most successful property developers to come out of the 1950's building boom. The three towers, Bernard House, Sunley House and Piccadilly Hotel were completed and in 1965, Piccadilly Plaza officially opened its doors. (Legend has it that it was a non-negotiable condition of Sunley's taking the job that the towers would bear his name.)

< Archive shot of City Tower

Ahead of the curve

Building styles dance in and out of fashion, often falling victim to the bulldozer, but for nearly 60 years, City Tower has stood tall and remains a cherished landmark of Manchester's ever-evolving skyline.

As you make it your home, you'll be welcomed into a thriving, vibrant community where you can exchange

ideas, push boundaries and embrace a future of unfettered possibilities. Feel good about where you work, knowing you're making your mark on the world.

[Skylounge auditorium >](#)





At the centre of it all

City Tower is strategically convenient. Whatever you need, the building is both a one-stop destination and a gateway to Manchester. Its ultra-accessible location is handy for the metro, free shuttle bus, rail, and Manchester Airport. And, with coffee shops, food outlets, gym and Metro stores all within its walls, you can

find everything essential for your daily life with ease.

The building's central location also connects you to the vibrant soul of Manchester, where every street corner is bursting with life and character.

A one-stop destination

< City Tower

Bridgewater Hall

Great Northern

Manchester Central

Central Library

Town Hall

Manchester Art Gallery

CITY TOWER

Piccadilly Gardens

MCR Arndale

Victoria Station

Ducie Street

Tariff Street

SALFORD CENTRAL

DEANSGATE

ST PETERS SQ

EXCHANGE SQ

VICTORIA

MARKET ST

PICCADILLY GARDENS

NORTHERN QUARTER

PICCADILLY

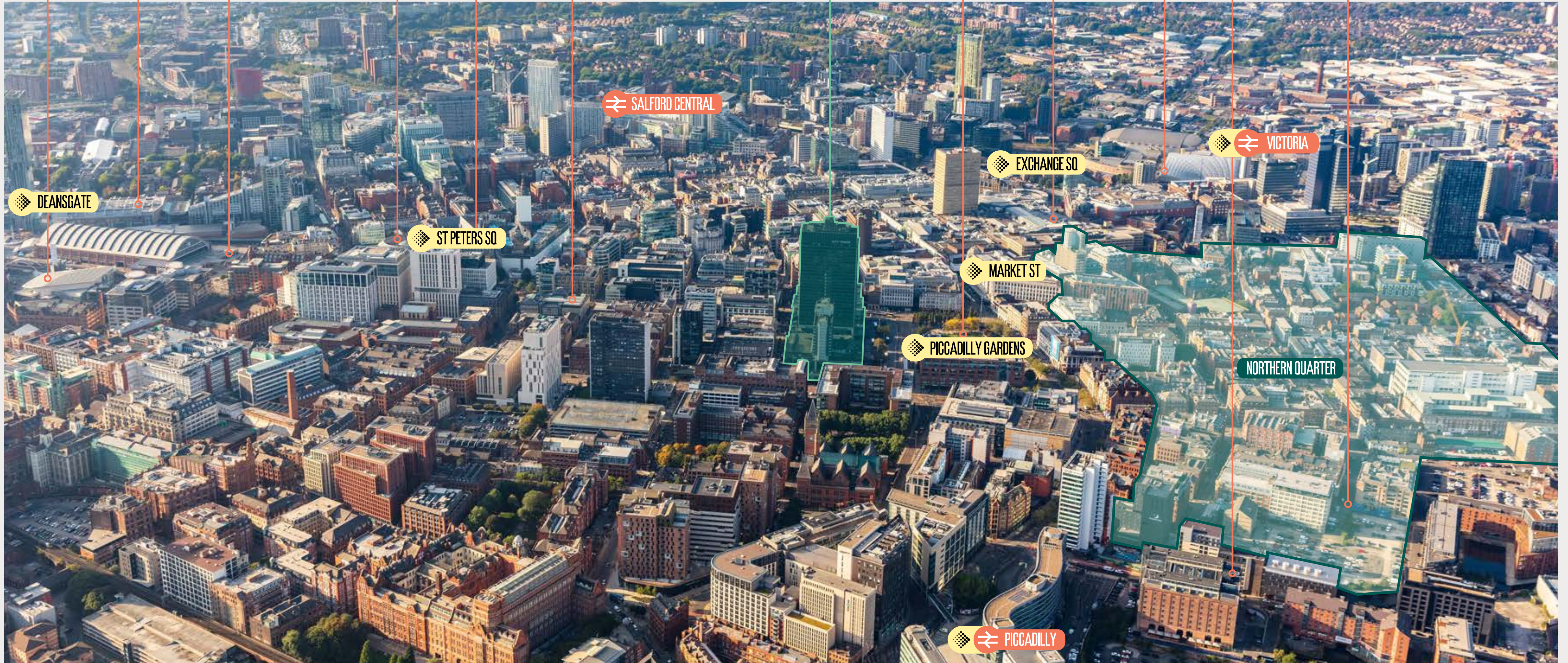

Moments from everywhere

City Tower has unrivalled connectivity with local and national transport networks on your doorstep

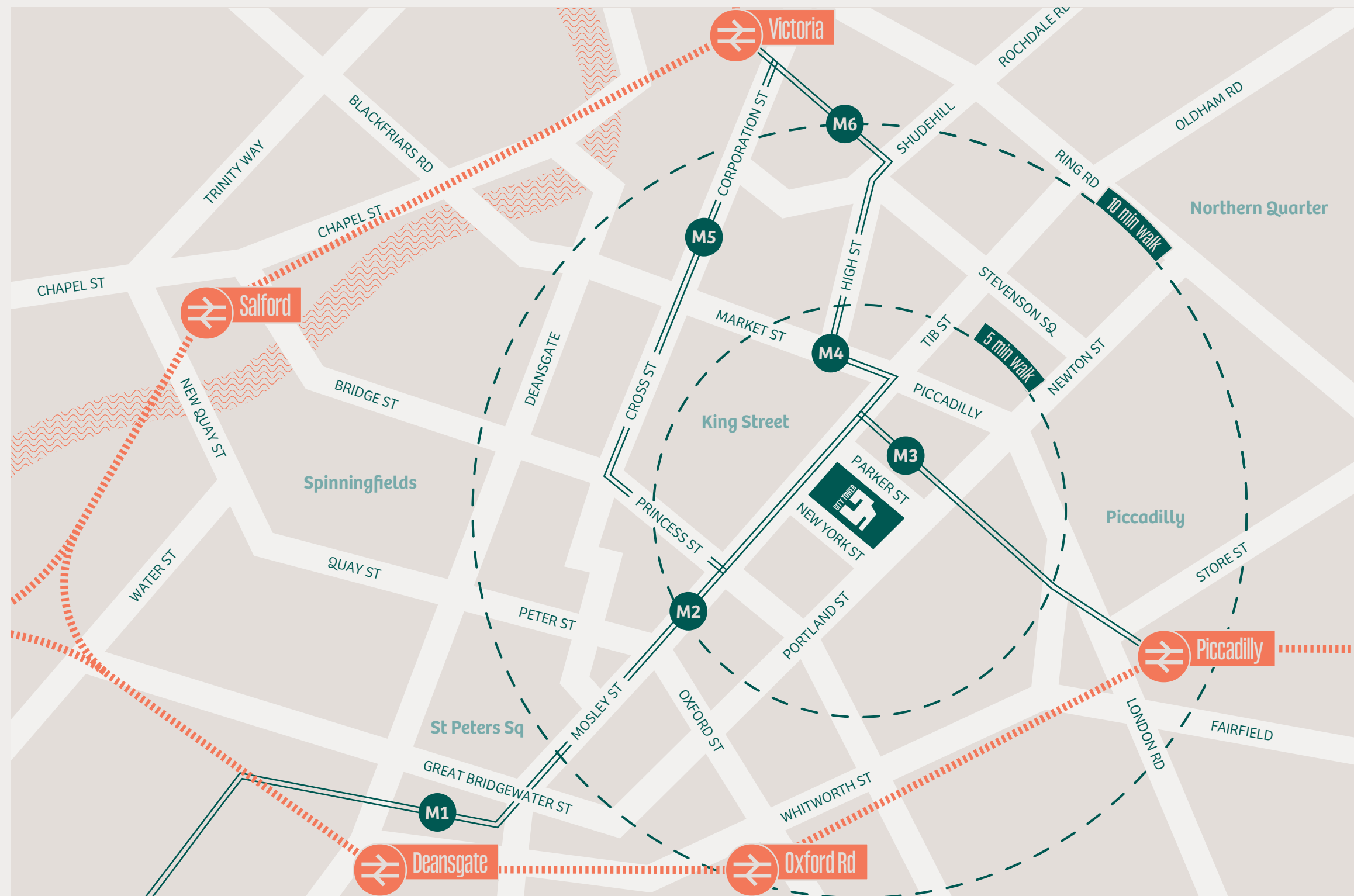

- Metrolink Line**
- M4 Market Street**
- M1 Deansgate-Castlefield**
- M6 Shudehill**
- M3 Piccadilly Gardens**
- M2 St Peter's Square**
- M5 Exchange Square**
- Train Line**
- Train Station**

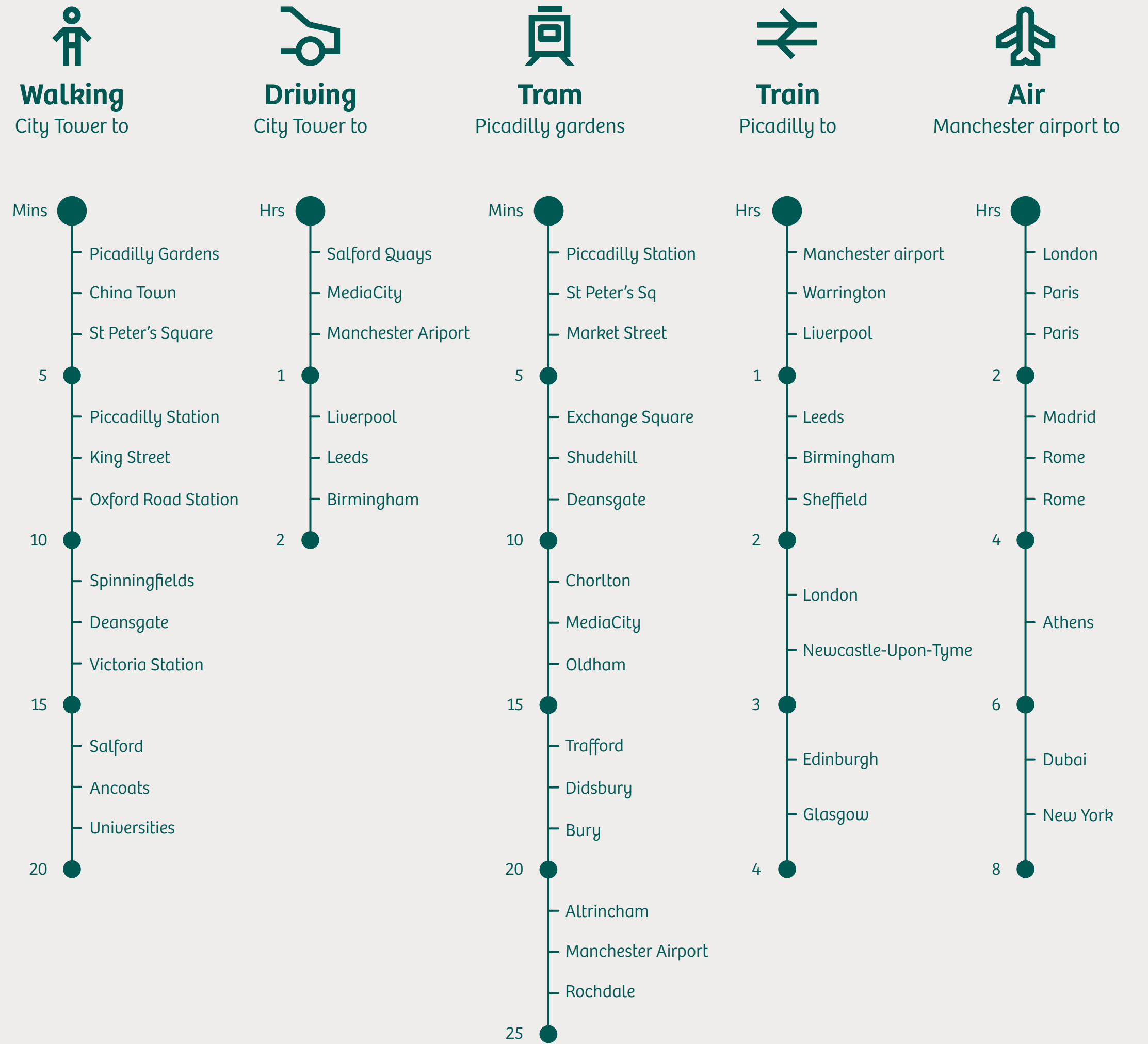

A THRIVING, VIBING COMMUNITY





Everything for effortless daily life

Alongside its great urban surroundings, City Tower nurtures within to enrich the everyday. Inside its walls, you'll find everything essential for effortless daily life. A brilliant retail scene awaits you on the ground floor, with an eclectic ensemble of shops and restaurants to meet your every need.

Start your day the right way – with freshly-brewed coffee, of course.

< [Piccadilly Gardens](#)

The on-site Starbucks is right there waiting for you as you walk through the entrance.

If you're looking for a light bite when lunchtime rolls around, Tesco Express, Nudo Sushi Box and Tegtat have got you covered. Brimming with meal deals, snacks and drinks, you can feel energised for the rest of your day.

Wondering where to go for something special? Try Namii, the Vietnamese restaurant and cocktail bar with menus inspired by the culture's mythology and folklore. This hotspot has quickly emerged as a force to be reckoned with in Manchester's hospitality scene, collecting numerous award nominations.

The main central foyer hosts a pop-up shed too – a charming retail space that rotates its lineup of small

businesses every one to two weeks. Many independent treasures have been known to grace the shed, from florists adorned with colourful blooms, to artisan confectioners, to local jewellers. It proudly embraces Mancunian entrepreneurship, ensuring that each visit brings an exciting array of new experiences for our esteemed residents to enjoy.

[▼ Namii](#)

[Main central foyer >](#)





Ducie Street

Just a short walk away is Ducie Street Warehouse, a fashionable hotspot that's kept its original industrial charm. You'll find plenty to love here, from the sophisticated bar and restaurant to the great outdoor terrace, and even a mini cinema that shows cult classics. Satisfy your sweet cravings with a visit to Gooey,

^ Ducie Street warehouse

its famous next door neighbour that serves up delicious doughnuts and cookies. And if you or your clients need to stay in town overnight, you can book one of its many stylish rooms.

Piccadilly Gardens

City Tower's doorstep opens up to Piccadilly Gardens, a bustling area that has recently undergone a huge transformation. It now boasts a shiny new turf and a festival pop-up area with bars and food stalls, making it an ideal spot for lunch or drinks.

^ Piccadilly Gardens



St Peter's Square

St Peter's Square is a five-minute stroll from the building and is steeped in history and culture. Overlooking this lively urban corner is the town hall — a proud symbol of Manchester's illustrious heritage. This has served as the backdrop for countless film and TV favourites, including *Peaky Blinders* and *The Iron Lady* with

Meryl Streep. There's also the Manchester Art Gallery and the Central Library, two renowned gems that capture the essence of the city's creative spirit. When it's time to eat, Wagamama or the Anthologist are perfect spots for a quick bite.

~ St Peter's Square Metrolink



Tariff Street Area

~ Tariff Street

Looking for something more laidback? Try the Tariff Street area just down the road. El Capo, Pen and Pencil, and Tarriff & Dale are all fantastic places to eat and drink, and surrounding spots like Cottonopolis and Feel Good Club add to its trendy

atmosphere. This patch of Manchester is effortlessly cool, and ideal for winding down after a long day in the office.

At a glance

● Cafés

1. Bunsik
2. Do Eat
3. Gong Cha
4. Tegtat
5. Starbucks
6. Foundation
7. Giovannis
8. 200 degrees

○ Hotels

9. Cove
10. Double Tree by Hilton
11. Malmaison
12. Mercure
13. Britannia

● Restaurants

14. The Alchemist
15. Bundobust
16. Franco Manca
17. Namii Kitchen & Cocktails
18. Nudo Sushi Box
19. Six by Nico
20. Yuzu
21. Vegan Shack
22. Barburrito
23. Shoryu

● Supermarkets

24. Morrisons
25. Tesco Express

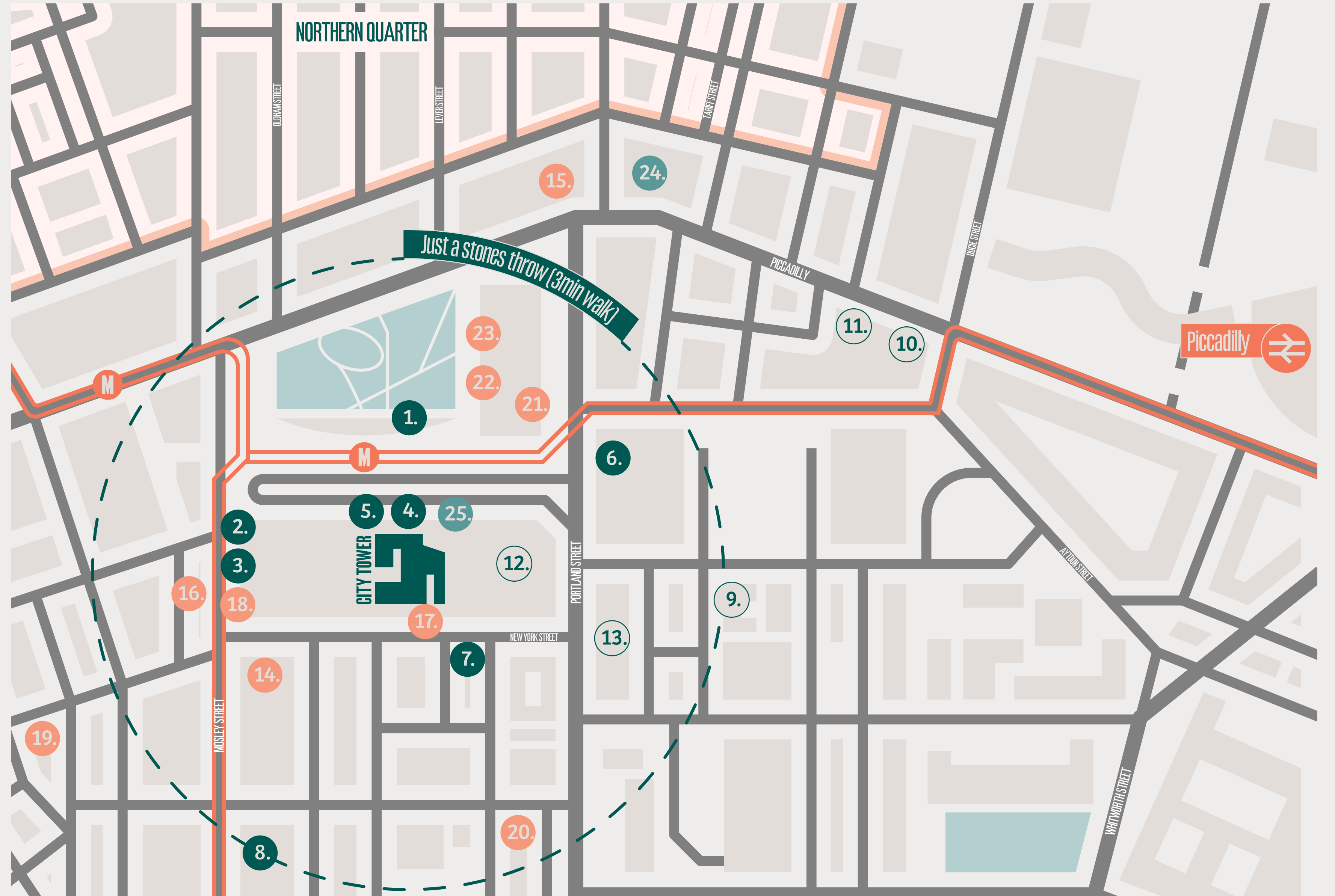



**MAKE YOUR
MARK ON THE WORLD**

Our building

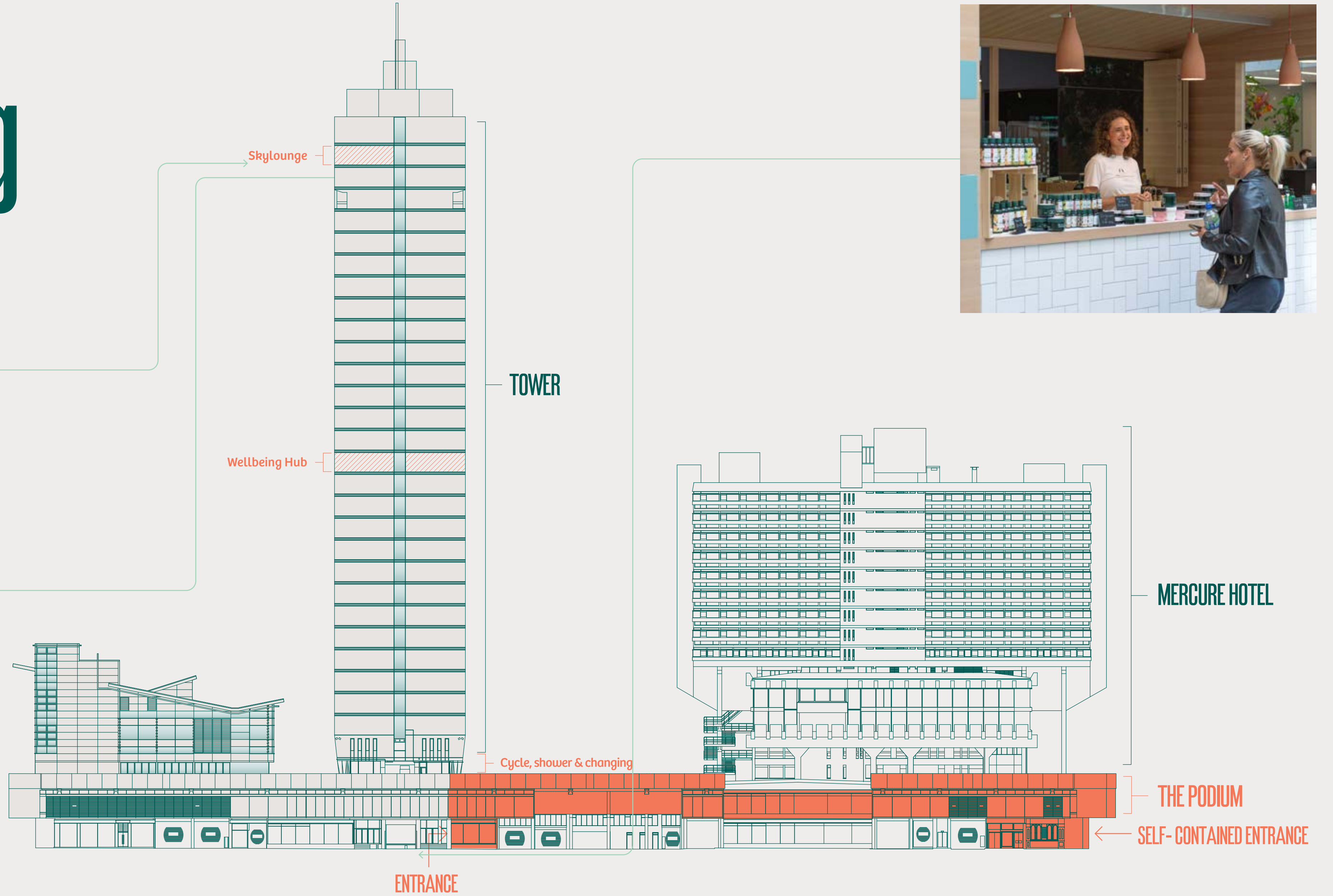

Repurpose + reuse

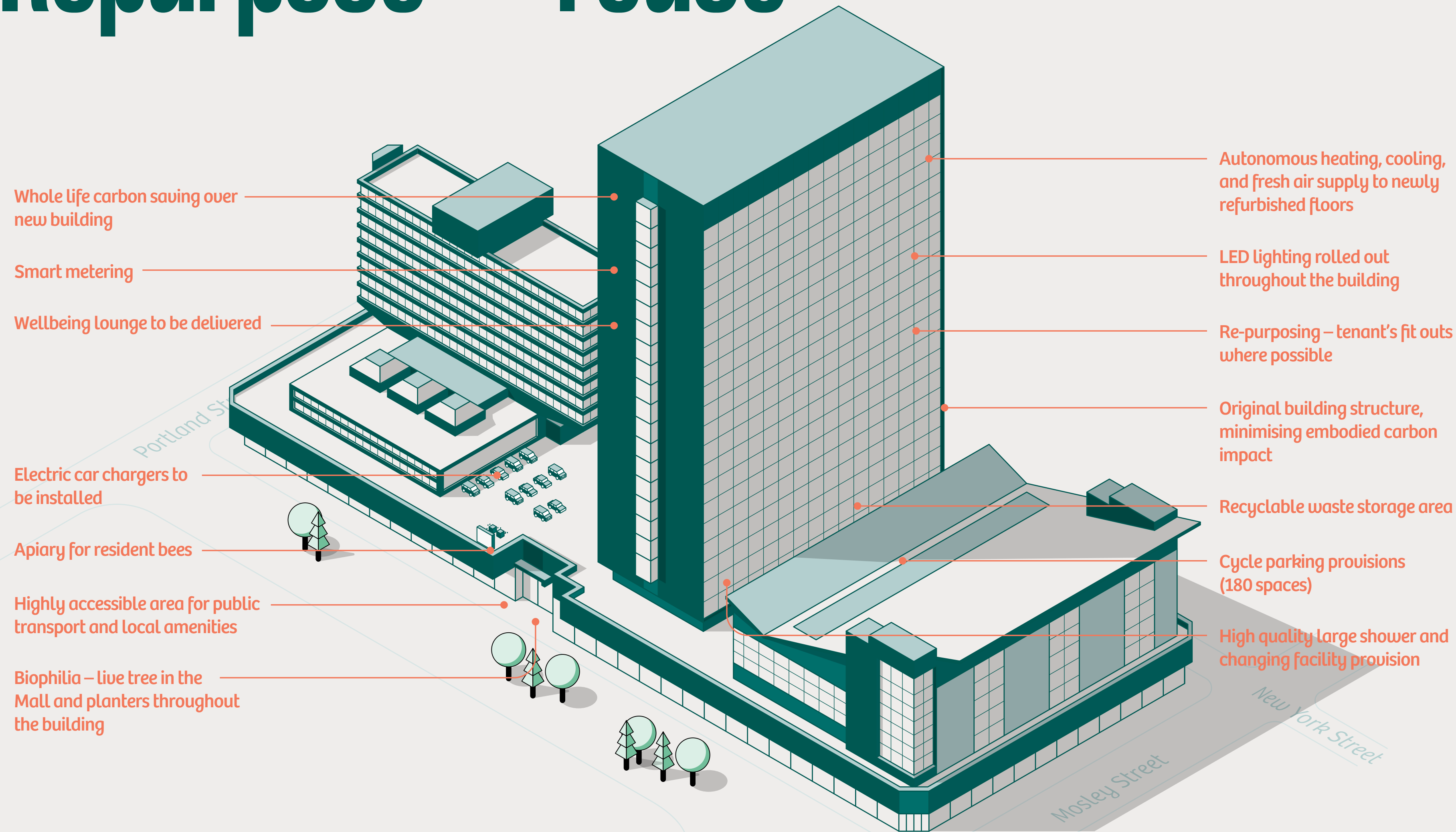

BREEAM in use rating:
Very good

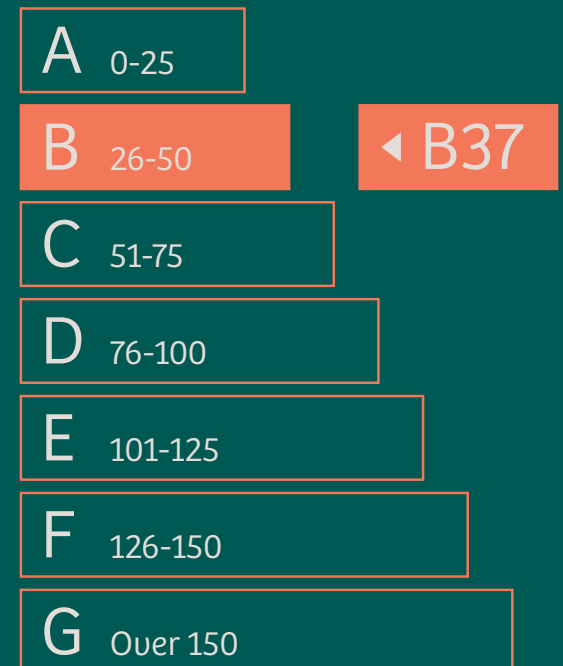

EPC rating:
B

Building amenities

Sushi restaurant Gong Cha >



Skylounge – 28th floor business lounge and events space



On-site building management with 24/7 concierge service



Changing and drying room facilities at Podium level (48 lockers)



Dedicated showers at Podium level (9 showers & 1 accessible shower)

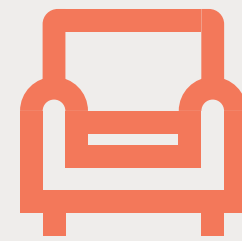

Ground floor business lounge



Secure bicycle storage (65 bike racks & 44 lockers)



Regular on-site fitness classes (yoga and pilates) and events for tenants



Disabled access

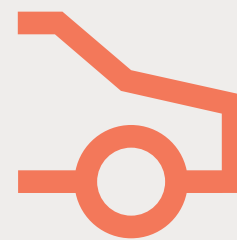

On-site car parking



Extensive amenity offering at ground floor level – shops, bars, restaurants and hotel



Wired Score Platinum - High speed internet with access to a range of providers



Greater Manchester Cycle Hub situated on-site



Connectivity

At City Tower, everyone is connected. WiredScore's Platinum rating guarantees the most resilient wireless network for all tenants, wherever you are in the building. With a host of provider options to choose from — BT Openreach, Virgin, Vodafone, or M247 — you can select the optimum fit for your needs.



Wiredscore:
Platinum



A host of provider
options to choose from

[Skylounge >](#)



**YOUR FUTURE
IS BOUNDLESS**



Skylounge

Perched atop the magnificent 28-floor building is City Tower's Skylounge. Proudly reigning as Manchester's highest lounge and space, this opulent workspace treats its guests to the city's most enviable panoramic view.

Gone are the days of cumbersome booking procedures too: simply sign in, turn up, and instantly immerse yourself in the opulence.

But Skylounge is more than just a meeting space; it's a vibrant community. Connect with fellow tenants and forge valuable relationships, exchange ideas,

and be inspired by the energy of collaboration. Regular tenant catch-up meetings foster a sense of belonging, ensuring that you're part of a supportive and engaged ecosystem.

The city's
most enviable
panoramic view

[Skylounge breakout space >](#)





Our promise to enhance your experience is unwavering. Our dedicated team of hospitality experts are always at your service, committed to creating memorable experiences. From setting up events to providing personalised assistance, they are the heartbeat of Skylounge, ensuring your every need is met with unrivalled attention to detail. We

value your feedback and continuously strive to improve our services within the building, guaranteeing that your experience here is nothing short of extraordinary.

With premium amenities, spectacular views, and a community to propel your success, Skylounge is sure to leave a lasting impression every time.

[< Skylounge](#)

Create memorable experiences

[Skylounge boardroom >](#)



Let's work well together

City Tower honours your work-life balance. That's why we've created an inclusive community where individuals feel supported, both professionally and personally. We care about the camaraderie within our walls, and we're proud to provide more than just a workspace. Our holistic approach to wellbeing extends beyond office hours, and we warmly welcome everyone in our building to our many activities and events.

More than just a workspace

[Skylounge auditorium >](#)





It's what we do best

The management strategy of City Tower underpins the vision and values of Schroders, with an emphasis on customer care. At City Tower, the occupier is central to all that we do and we are keen to ensure we remain in close contact with you to ensure the building is servicing all of your needs.

All services sourced to operate the building are done so in an ethical and sustainable manner to promote both environmental and social values.

Community is at the heart of City Tower and a cohesive and interactive programme of occupier events is offered at the building, underpinning the values above and fostering a sense of social and business collaboration between our tenants.

We want City Tower to be an engaging, stimulating environment in which to work and take pride in the fact that operations and an operating ethos help support the wider local community.

"We're always here to help, no matter how big or small"

Jacqui Stepney: Building Manager

< Main central foyer

A sanctuary for mindfulness

Unwind and restore your energy with our weekly yoga classes. Set against the beautiful backdrop of Manchester's skyline, these expert-led sessions offer a sanctuary of tranquillity amidst the bustling urban landscape. Choose from two unique yoga styles to nurture your inner balance.

Celebrate together

Our events calendar is packed with seasonal festivities that bring the community together in delightful ways. From our whimsical Easter egg hunt to our Halloween-themed workshops and tarot sessions, there's always something special happening at City Tower.



Active living

Unleash your competitive spirit at our City Tower Trigames. Rally your teams and strategise your moves as you join your neighbours in table tennis, football tournaments, and even a cycling race.

~ Workshop

< Yoga class

Cultural delights

Expand your horizons with our cultural workshops. From traditional tea ceremonies and Mandarin taster lessons to captivating sessions on Chinese calligraphy, our immersive experiences open the door to the beauty of global traditions.



Contact us



Andrew Cowell

acowell@obiproperty.co.uk
07584 990 976
0161 237 1717

Debbie Meredith

dmeredith@obiproperty.co.uk
07920 422 291
0161 237 1717



James Devany

james.devany@jll.com
07525 582 901
0161 238 6233



Harry Skinner

harry.skinner@cushwake.com
07775 711 136
0161 455 3713

OBI, JLL and Cushman & Wakefield give notice that these particulars are set out as a general outline only for the guidance of intending Purchasers or Lessees and do not constitute any part of an offer or contract. Details are given without any responsibility and any intending Purchasers, Lessees or Third Party should not rely on them as statements or representations of fact, but must satisfy themselves by inspection or otherwise as to the correctness of each of them. No person employed or engaged by OBI has any authority to make any representation or warranty whatsoever in relation to this Property. These details are believed to be correct at the time of compilation, but may be subsequent amendment. Brochure designed and produced by OBI, October 2023.

Managed by: **MAPP**

City Tower, New York St, Manchester, M1 4BT

