

Floor Plans

UNIT 4 - 2463 SQ FT | RIVERMEAD BUSINESS PARK

Pipers Way, Thatcham, RG19 4EP

Rivermead Business Park, Pipers Way, THATCHAM
Approximate Gross Internal Area
2469 Sq Ft/229 Sq M

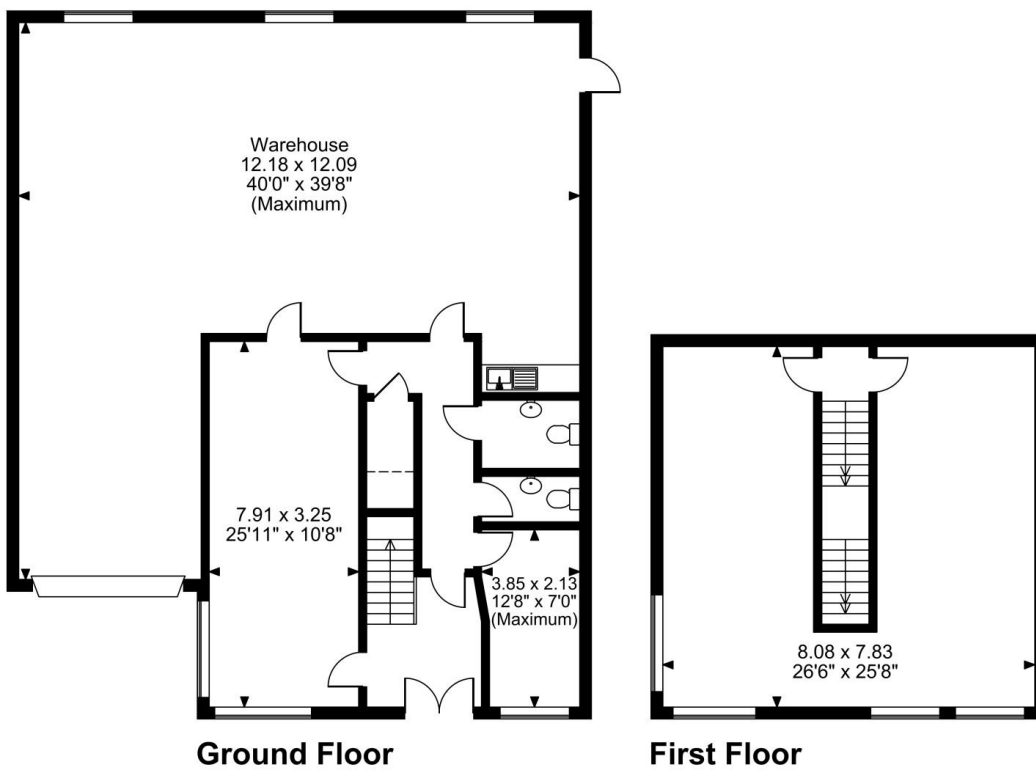
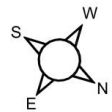

FOR ILLUSTRATIVE PURPOSES ONLY - NOT TO SCALE

The position & size of doors, windows, appliances and other features are approximate only.

 Denotes restricted head height

© ehous. Unauthorised reproduction prohibited. Drawing ref. dig/8630403/JLW