

Floor Plans

UNIT 31 - 88382 SQ FT | MEON VALE BUSINESS PARK

Campden Road, Stratford-upon-Avon, CV37 8QR

Meon Vale Business Park, Long Marston, Campden Road, Stratford-upon-Avon
Approximate Gross Internal Area
88993 Sq Ft/8268 Sq M

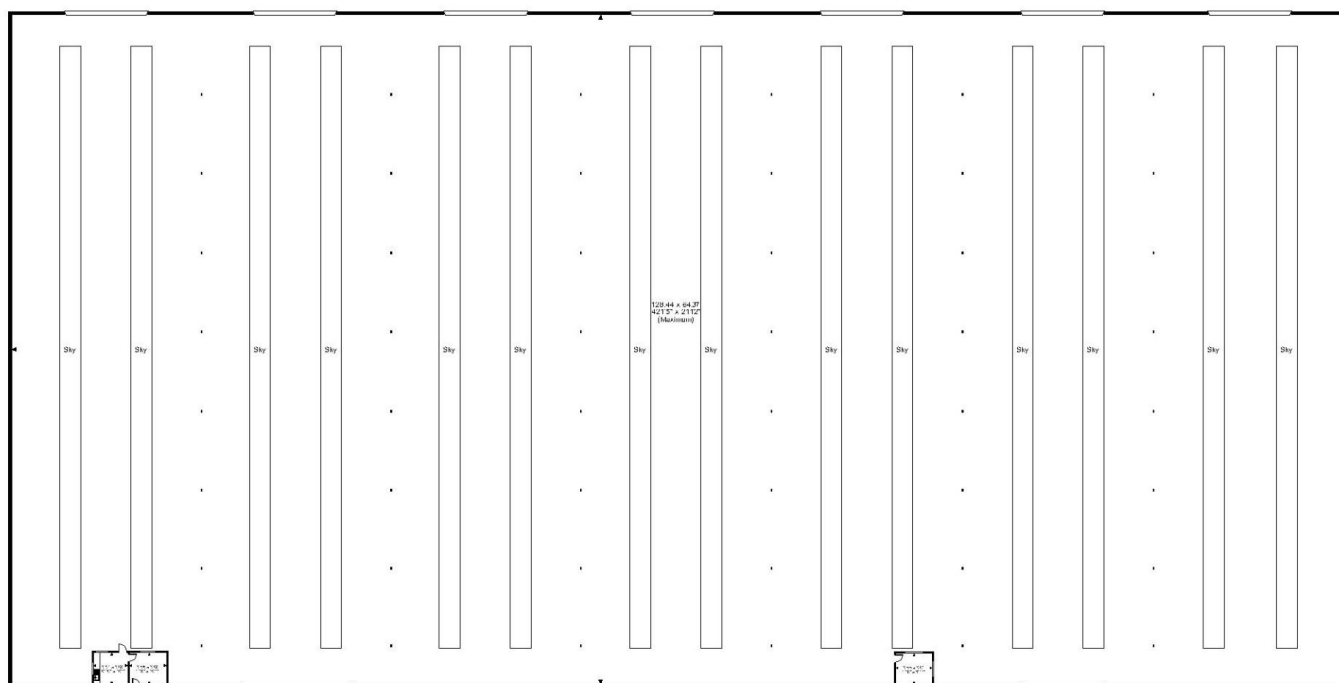
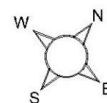

Ground Floor

FOR ILLUSTRATIVE PURPOSES ONLY - NOT TO SCALE

The position & size of doors, windows, appliances and other features are approximate only.

© ehouse. Unauthorised reproduction prohibited. Drawing ref. dig/8625918/MKB